

Scheda Tecnica *Technical sheet*

ART.553	SPECIFICATION		APPLICATION	TECHNICAL NOTES
	<i>Forged brass ball valve, reduced port, FF, with steel handle. Size. from 1/2" to 2".</i>	Series	0553	Assembly in rigid pipe system
Thread ends		Female-Female UNI EN 10226	Nominal pressure (PN) in bar: MOP5	
Orifice		from 12 to 40 mm	KV: Flowrate coefficient m ³ /h	All valves are 100% tested with electrically controlled pneumatic seal test.
Actuator		90° rotation with mechanical stop	Direction of flow: as desired	
Operator		Steel handle	Temperature range: -20°C / +60°C	2 YEARS warranty
		Use: Gas	Manufactured in brass alloy compliant with EN 12165-CW617N	

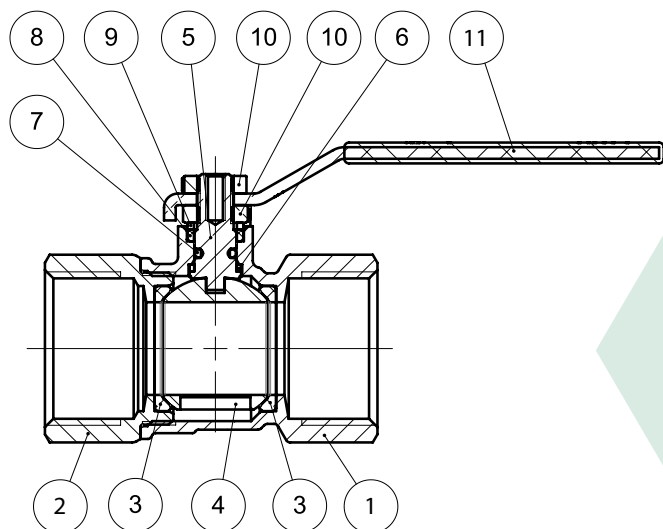

N°	Descrizione	Description	Materials	Treatment	Q.ty
1	Corpo	Body	CW617N	Nickel Plated	1
2	Manicotto	End connection	CW617N	Nickel Plated	1
3	Guarnizione sede sfera	Ball seal	PTFE		2
4	Sfera	Ball	CW617N	Ni+Cr	1
5	Perno	Stem	CW614N		1
6	Guarnizione Inferiore	Lower seal	PTFE		1
7	O-ring	O-ring	NBR70sh		1
8	Guarnizione Superiore	Upper seal	PTFE		1
9	Rondella	Brass Ring	CW614N		1
10	Dado	Nut	STEEL	Zinc-plated	2
11	Leva	Handle	STEEL	Printed	1

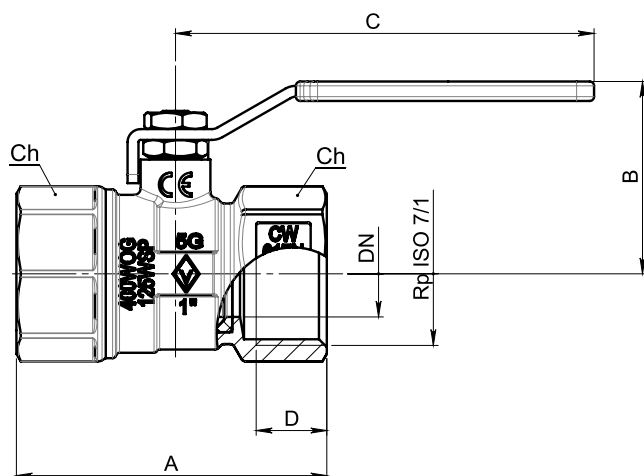

DN	Rp	A	B	C	D	Ch	PN
12	1/2"	55,5	38,5	85	12,7	25	MOP5
15	3/4"	63,5	40,5	85	14,5	31	MOP5
20	1"	71	44	96	16,8	38	MOP5
25	1"1/4	83,5	51	96	18,5	48	MOP5
32	1" 1/2	89,5	56,5	118	18,5	54	MOP5
40	2"	109	63	118	22,7	67	MOP5